

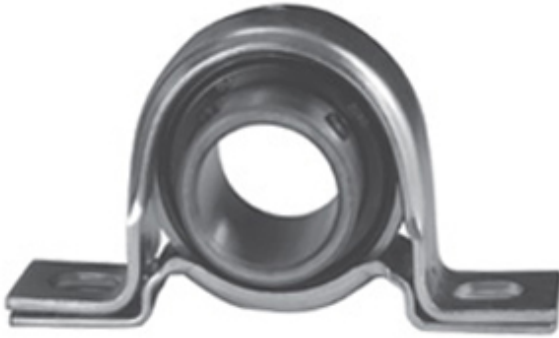

REXNORD BEARING LIMITED

0.688 Inch | 17.475 Millimeter x 0.984 Inch | 25
Millimeter x 0.875 Inch | 22.225 Millimeter LINK
BELT PSS211E Pillow Block Bearings



PSS211E Bearing 2D drawings and 3D CAD models

Bearing No. PSS211E

Category	Pillow Block Bearings
Inventory	0.0
Manufacturer Name	REXNORD
Minimum Buy Quantity	N/A
Weight	0.2
EAN	0662864017817
Product Group	M06110
Number of Mounting Holes	2
Mounting Method	Set Screw
Housing Style	2 Bolt Pillow Block
Rolling Element	Ball Bearing
Housing Material	Stamped Steel
Expansion / Non-expansion	Non-expansion
Mounting Bolts	5/16 Inch
Relubricatable	No
Insert Part Number	MB25-1116-PA
Seals	Single Lip Contact
Housing Configuration	1 Piece Solid
Inch - Metric	Inch
Other Features	Single Row Standard Duty Has Flinger
Long Description	2 Bolt Pillow Block; 11/16" Bore; 7/8" Base to Center Height; Set Screw Mount; Ball Bearing; 2-1/2" Minimum Bolt Spacing;



REXNORD BEARING LIMITED

	2-7/8" Bolt Spacing Maximum; No Relubricatable; Stamped St
Category	Pillow Block
UNSPSC	31171511
Harmonized Tariff Code	8483.20.40.40
Noun	Bearing
Keyword String	Pillow Block
Manufacturer URL	http://www.rexnord.com
Manufacturer Item Number	PS25-1116
Manufacturer Internal Number	5805562
Weight / LBS	0.44
D	0.984 Inch 25 Millimeter
Bolt Spacing Minimum	2.5 Inch 63.5Millimeter
Actual Bolt Center to Center	0 Inch 0Millimeter
d	0.688 Inch 17.475 Millimeter
Nominal Bolt Center to Center	2.7 Inch 68 Millimeter
B	0.875 Inch 22.225 Millimeter
Bolt Spacing Maximum	2.875 Inch 73.025Millimeter